

# Cleats

We use this knot to secure the dock lines to cleats on the rail, the main sheet to the cleat on the wheel box, the halyards to the cleats on the mast and the pushboat lines to the cleats on the davits.



Step 1:  
Bring the line in over the rail, around the far side of the cleat and back up on the other side.



Step 2: Full Wrap  
Take the line over the cleat and around, to make one full wrap.

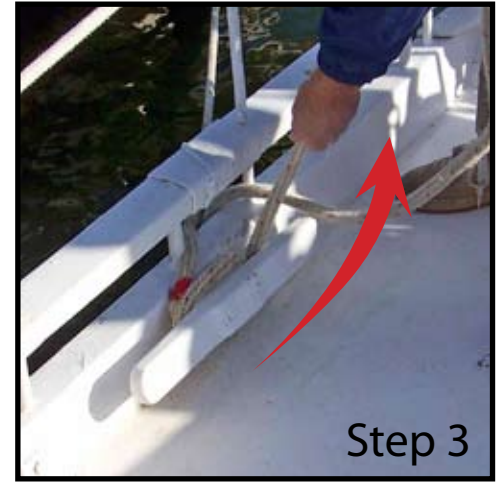

Step 3:  
Bring the line up on the other side again.



Step 4: Figure 8 Wrap  
Take the line diagonally down and across the front of the cleat, bringing it up again in the opposite direction of the first wrap.



Step 5:  
Give the line a counterclockwise half twist and form a loop. Place it over the horn so that the beginning of the loop comes diagonally down and across the front of the cleat and lies over the end of the line, which should lie parallel to the diagonal wrap in step 4.

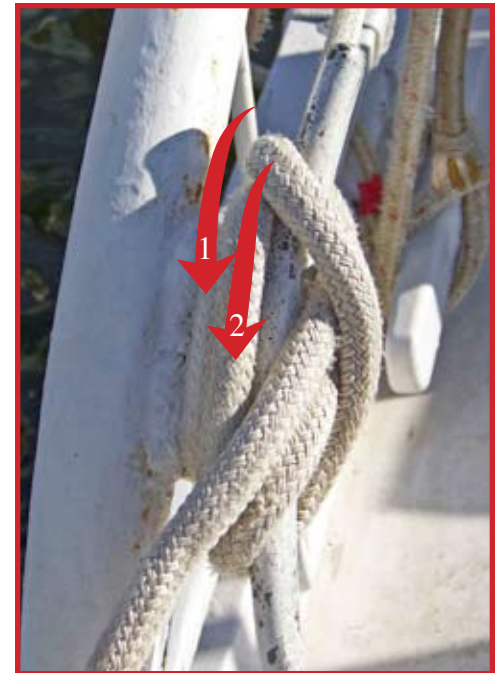

A variation that we use on the cleats that hold the pushboat lines is to take TWO full wraps (repeat steps 2 and 3 after step 3) before starting the figure 8 wraps. The weight of the pushboat creates a tension on the line that can make it difficult to release without an extra wrap to take the strain. It also can help protect against accidental release of the line.



Step 6:  
Pull the line up around the cleat firmly to tighten the loop.

## Knots: The Nathan Way